

PIN	1	2	3	4	5	6	7	8	9	10	11	12
COM1				COM1	1F	1A	2F	2A	3F	3A	4F	4A
COM2			COM2	1G	1B	2G	2B	3G	3B	4G	4B	4C
COM3			COM3		1E	1C	2E	2C	3E	3C	4E	4C
COM4			COM4		1D	1D	DOT	2D		3D		4D

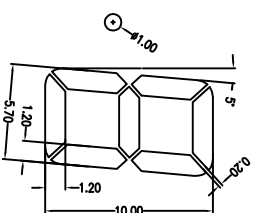

Specification

1. Display mode: FST/POSITIVE/REFLECTIVE, Viewing angle: 12 O'clock
2. Driving condition: 1/4Duty, 1/3Bias, Vop: 3.0V
3. Operating temp: -0°C~50°C, Storage temp: -10°C~60°C
4. Back light: Non
5. Back light color chromaticity:
6. Uniformity of the lightguide more than 80%
7. Unspecified tolerance : ±0.20mm
8. Remark : ROHS

Count drawing & Spec.revision record during discussion with customer

Rec.#	Revision content description	Date
#00	FIRST ISSUE	2014.09.24

JASONIC TECHNOLOGY LIMITED

Mod.Name JF-1404A6

UNIT	SIZE	DESIGNER	CHECK	APPROVER
mm	A4			



SCALE	SHEET
NTS	1/1

FILE NAME
Count Dwg.